

## Low Profile POWER INDUCTORS - SDB1003 SERIES



### PART NUMBERING SYSTEM

<b>SDB</b>	<b>1003</b>	—	<b>681M</b>	—	<b>LF</b>
TYPE	DIMENSIONS		INDUCTANCE		LEAD FREE

### SHAPES AND DIMENSIONS

UNIT : mm

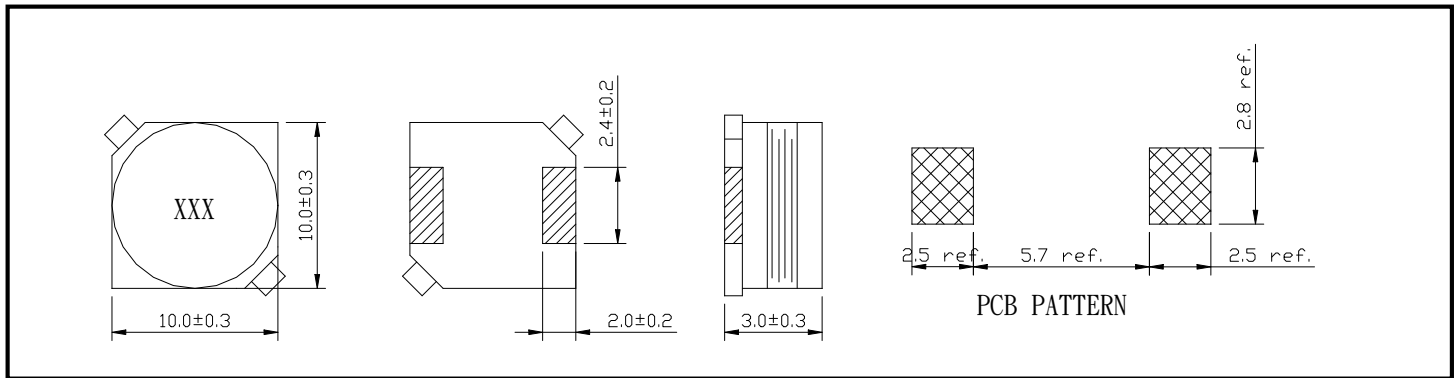

### PACKAGING SPECIFICATION

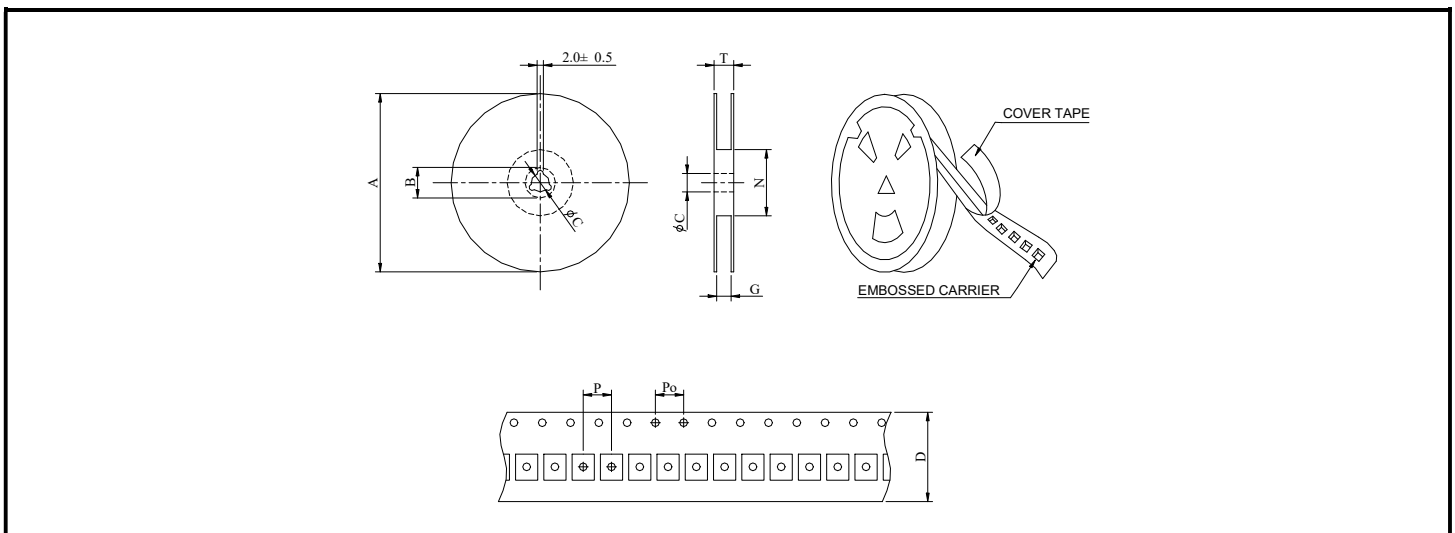

SERIES	STAYLE	Q' TY (PCS)	DIMENSIONS (m/m)								
			A	B $\pm 0.8$	C $\pm 0.5$	D	G <sup>+0</sup>	N <sup>0</sup>	P	Po	T
SDB1003	13-24	1000	330	21	13	24	26	50	16	4	30.4

## SPECIFICATION TABLE

PART NUMBER	INDUCTANCE ( $\mu$ H)	DCR ( $\Omega$ ) (Max.)	IDC ( A ) (Max.)	TEST FREQ. ( Freq. )
SDB1003-1R8M-LF	1.8 $\pm$ 20%	0.027	4.00	100KHz
SDB1003-2R7M-LF	2.7 $\pm$ 20%	0.030	3.65	100KHz
SDB1003-3R9M-LF	3.9 $\pm$ 20%	0.035	3.15	100KHz
SDB1003-4R7M-LF	4.7 $\pm$ 20%	0.040	3.00	100KHz
SDB1003-6R8M-LF	6.8 $\pm$ 20%	0.050	2.35	100KHz
SDB1003-100M-LF	10 $\pm$ 20%	0.060	2.20	100KHz
SDB1003-120M-LF	12 $\pm$ 20%	0.080	2.00	100KHz
SDB1003-150M-LF	15 $\pm$ 20%	0.100	1.75	100KHz
SDB1003-180M-LF	18 $\pm$ 20%	0.110	1.70	100KHz
SDB1003-220M-LF	22 $\pm$ 20%	0.140	1.60	100KHz
SDB1003-270M-LF	27 $\pm$ 20%	0.160	1.40	100KHz
SDB1003-330M-LF	33 $\pm$ 20%	0.210	1.20	100KHz
SDB1003-390M-LF	39 $\pm$ 20%	0.235	1.10	100KHz
SDB1003-470M-LF	47 $\pm$ 20%	0.280	1.00	100KHz
SDB1003-560M-LF	56 $\pm$ 20%	0.320	0.90	100KHz
SDB1003-680M-LF	68 $\pm$ 20%	0.370	0.85	100KHz
SDB1003-820M-LF	82 $\pm$ 20%	0.430	0.75	100KHz
SDB1003-101M-LF	100 $\pm$ 20%	0.560	0.70	100KHz
SDB1003-121M-LF	120 $\pm$ 20%	0.640	0.60	100KHz
SDB1003-151M-LF	150 $\pm$ 20%	0.730	0.55	100KHz
SDB1003-181M-LF	180 $\pm$ 20%	0.960	0.50	100KHz
SDB1003-221M-LF	220 $\pm$ 20%	1.100	0.48	100KHz
SDB1003-271M-LF	270 $\pm$ 20%	1.240	0.45	100KHz
SDB1003-331M-LF	330 $\pm$ 20%	1.640	0.38	100KHz
SDB1003-391M-LF	390 $\pm$ 20%	1.790	0.35	100KHz
SDB1003-471M-LF	470 $\pm$ 20%	2.050	0.30	100KHz
SDB1003-561M-LF	560 $\pm$ 20%	2.890	0.29	100KHz
SDB1003-681M-LF	680 $\pm$ 20%	3.240	0.27	100KHz
SDB1003-821M-LF	820 $\pm$ 20%	3.700	0.25	100KHz
SDB1003-102M-LF	1000 $\pm$ 20%	7.000	0.24	100KHz

- DC current at which the inductance drops 10% (typ) from its value without current.
- Operating temperature range -40°C to +125°C
- Electrical specifications at 25°C.
- Product comply with RoHS and REACH requirements
- Halogen free available
- Moisture sensitivity Level 1 (MSL 1)
- Custom versions available
- Flat top for reliable surface mounting
- Suitable for Input/output of DC/DC converters
- Power supplies for portable communication equipment / Camcorders / LCD TVs